

# 25380 QUAIL SUMMIT LANE, MONTEREY, CA 93924

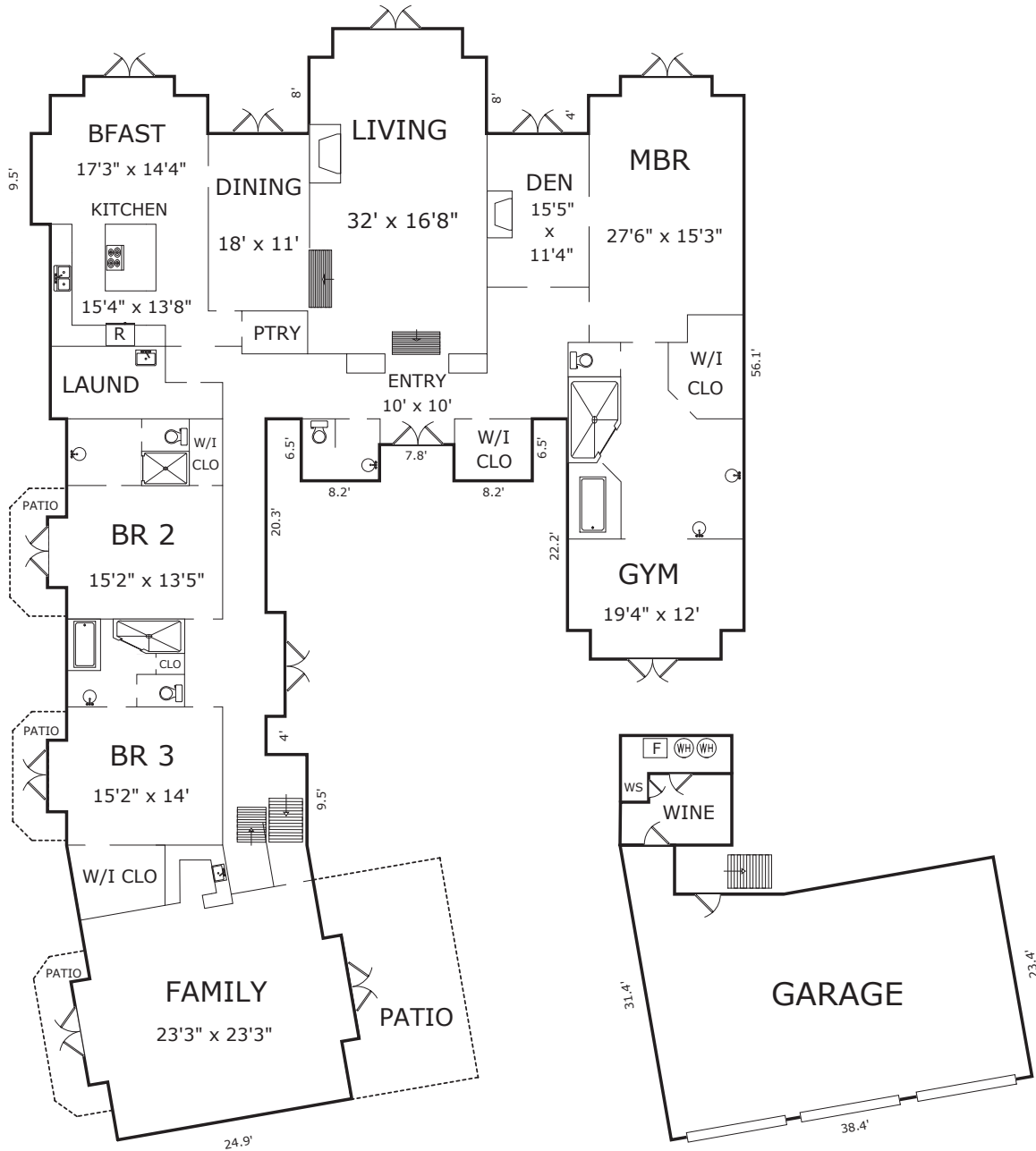

### AREA CALCULATIONS

Main Living Area:	4,926sf
Second Floor:	79
<b>Net Livable Area:</b>	<b>5,005sf</b>
Garage:	945
Patio:	294
Patio:	73
Patio:	60
Patio:	60